

VALIDATIONS

- Chambers: Refrigerators, Incubators, Stability, Freezers, Cryo-Freezers
- Sterilizers: SIP, Autoclaves, Depyrogenation ovens
- Warehouses and Rooms
- Lyophilizers, Bioreactors, Centrifuges
- Ovens, Vessels & Tanks, Fermentors
- Shipper containers
- Validator 2000 Validation
- Validation Training
 - Validator 2000 operational training
 - Specific qualification training



CALIBRATIONS

Equipment Calibrations

- Validation dataloggers (V2000, Digi, KL, Portables)
- Temperature standards (IRTD-400, Hart 1522/PRTs, SPRTs, etc.)
- Temperature reference baths (LTR, HTR, CTR, etc.)
- RH sensors, CO₂, pressure, etc.

On-Site Calibrations

- Validation dataloggers, chart recorders, controllers, indicators
- Chambers, centrifuges, balances, scales, gauges
- Temperature, RH, pressure CO₂, light, time, rotation, voltage, current, resistance, weight



EQUIPMENT RENTALS

Validation Dataloggers

- GE Kaye Validator 2000
- Digi, KL, Portable

Temperature Standards

- GE Kaye IRTD-400
- Hart handheld thermometer 1502A/1522 w/PRT

Temperature Reference Baths

- GE Kaye LTR, HTR, CTR
- Hart handheld drywell baths, portable furnaces

Particle Counters

Thermocouple Feedthroughs

Vaportron Portable Humidity Calibrator

Wireless Temperature and Humidity Transmitters

- GE ValProbes, DataTrace, Hanwell



BIOPHARMA STORAGE FACILITY

- LN₂ cryogenic temperature controlled storage
- -20°C Walk-in, 2 - 8°C Walk-in
- Reach in chambers at -80°C, -25°C and 2 - 8°C
- Walk-in and/or reach-in stability at 25°C/60%RH, 30°C/65%RH, 40°C/75%RH, and Photostability
- Ambient conditions also available

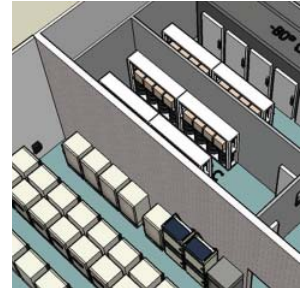

THERMOCOUPLE WIRE

Ultra Premium Select Grade, 7 Strand

Wire Rolls: Up to 10,000ft.

- FEP 22awg, FEP 28awg, Kapton® 22awg

Custom thermocouples: Made to order

- Harnessed, tipped, labeled



FACILITY MONITORING SYSTEMS

- Masy Commander Facility Monitoring System
- Hanwell Wireless Facility Monitoring System
- GE Kaye LAB watch Facility Monitoring System



DATALOGGERS

Hanwell Dataloggers: High accuracy temp/RH

- Chart recorder replacements or stand alone loggers
- LCD displays
- Sensor Ranges: -200°C to 110°C, 0 to 100%RH

Elpro: transport dataloggers

- Internal: -35°C to 70°C.
- External: -80°C to 85°C.



DISTRIBUTOR OF



FLUKE®

Hart Scientific®

- Temperature Calibration Measurement Equipment
- Thermometers, metrology baths



- Sanitary Gaskets and Clamps for the BioPharma Industry



- Electronic Locks with audit trail